

CERTIFICATE OF SURVEY
LOTS 36 AND 37, CLOUD PEAK ADDITION
 TO THE
CITY OF BUFFALO, WY

WALTERS STREET

L=29.11'
 R=20.00'
 $\Delta=83^{\circ}23'16''$
 Chord Brg = S 48°28'04" E
 Chord Length = 26.61'

N 89°50'17" E 67.72'

KLONDIKE DRIVE

KEARNEY AVE

LOT 36

AREA = 7,841 SF ±

42

92.79'

64.32'

N 00°01'27" W 162.93'

S 83°07'51" W 95.88'

S 06°46'26" E 134.13'

LOT 37

AREA = 6,973 SF ±

43

70.14'

69.81'

S 83°13'34" W 104.12'

38

LEGEND



- SET ALUMINUM CAP PELS 8663



- X MARKED ON BOULDER



- BOUNDARY LINE

CERTIFICATE OF SURVEYOR

STATE OF WYOMING }
 COUNTY OF JOHNSON } SS

I, Josh Johnson, a duly registered land surveyor in the State of Wyoming, do hereby certify that this plat was made from information from an actual field survey by me or under my direct supervision, and that it correctly represents the parcel surveyed, as staked on the ground in September of 2024, to the best of my knowledge and belief.

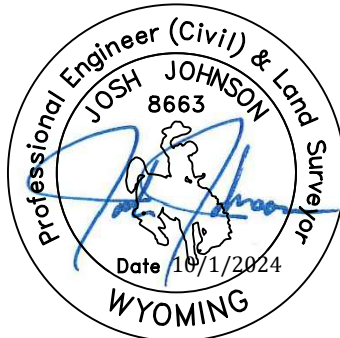

SCALE: 1"=30'

Job No: 21-94
Date: 10/1/2024
Page 1 of 1
Drawn by: AE
Checked by: JJ



Bighorn
Surveying &
Engineering, LLC

821 Fort Street Buffalo, WY 82834 (307) 684-7400 www.bighornsurveying.com

Prepared For:
 Josh & Cheri Carswell
 P.O. Box 272
 Monroe, WA 98272