

Building Sketch

Borrower					
Property Address	347 Main St				
City	Big Horn	County	Sheridan	State	WY
Lender/Client	Loco Properties, LLC & Mary Christine Love Revocable Trust				
				Zip Code	82833

Second Floor

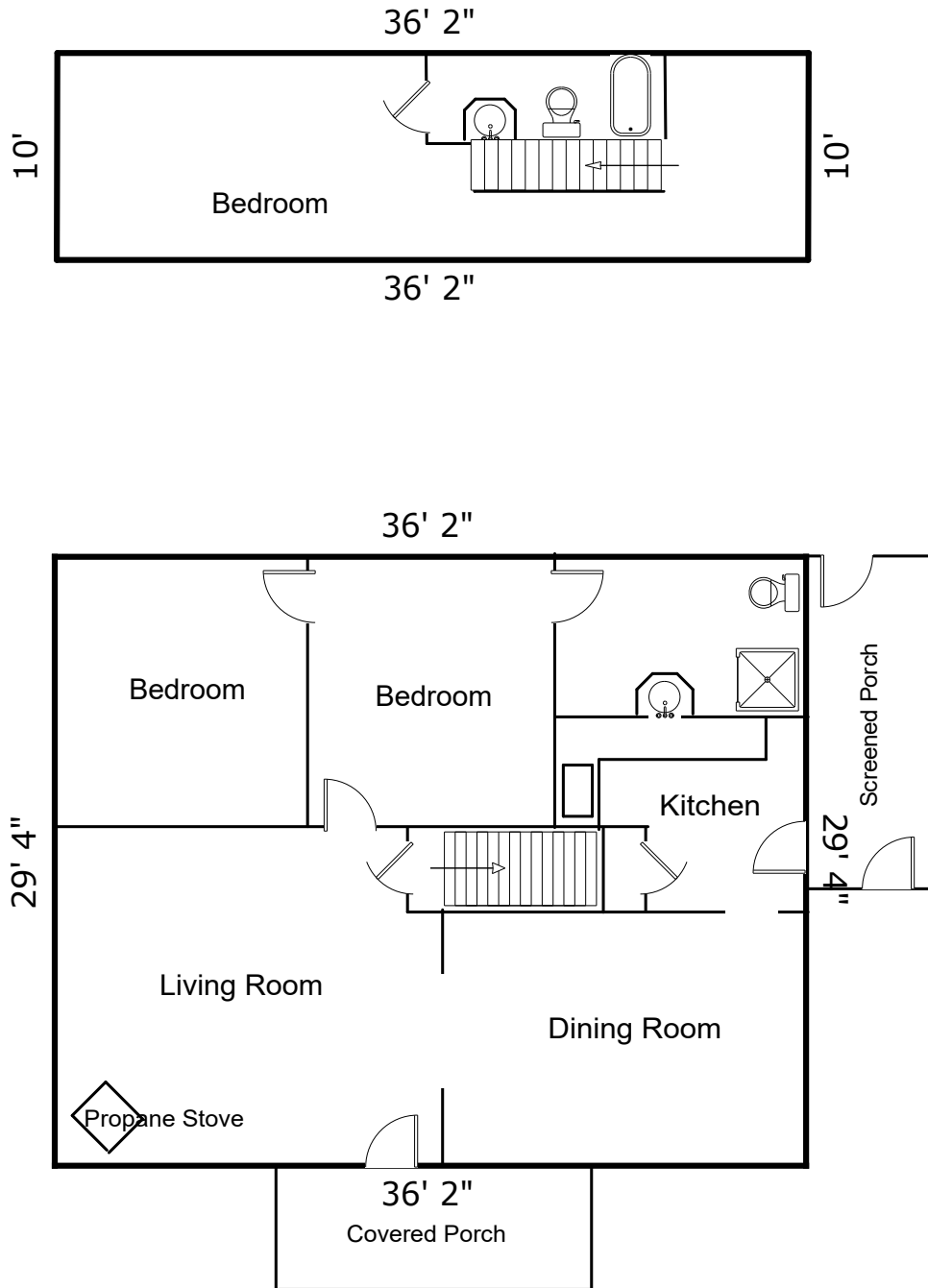

TOTAL Sketch by a la mode

Area Calculations Summary

Living Area	Calculation Details		
First Floor	1060.87 Sq ft	36.17×29.33	= 1060.87
Second Floor	360.47 Sq ft	36.15×9.97	= 360.24
		$0.5 \times 0.02 \times 9.97$	= 0.12
		$0.5 \times 0.02 \times 9.97$	= 0.12
Total Living Area (Rounded):	1421 Sq ft		